

DETAIL A
SCALE 2:1

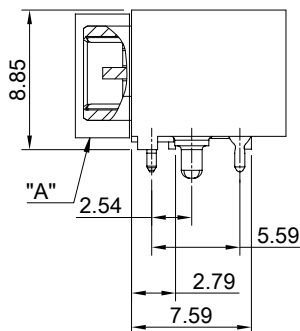
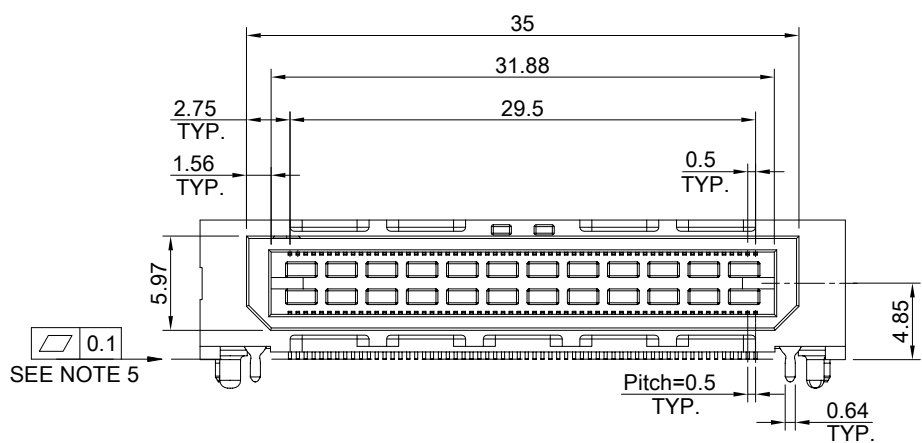
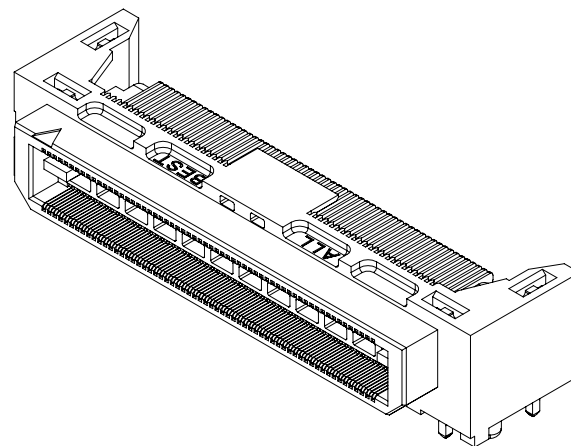

MATERIAL
CONTACTS: COPPER ALLOY
INSULATOR: LCP THERMOPLASTIC 94V-0

FINISH
CONTACTS: 5μ" MIN. GOLD ON MATING END;
100μ" MIN. MATTE TIN ON SOLDER FOOT AREA
ALL UNDERPLATED NICKEL

ELECTRICAL CHARACTERISTICS
CONTACT CURRENT RATING: 2 AMPERE
VOLTAGE RATING: 275VAC
MAX CYCLES: 100

ENVIRONMENT
OPERATION TEMPERATURE: -55°C TO 125°C
SMT TEMPERATURE: 260°C

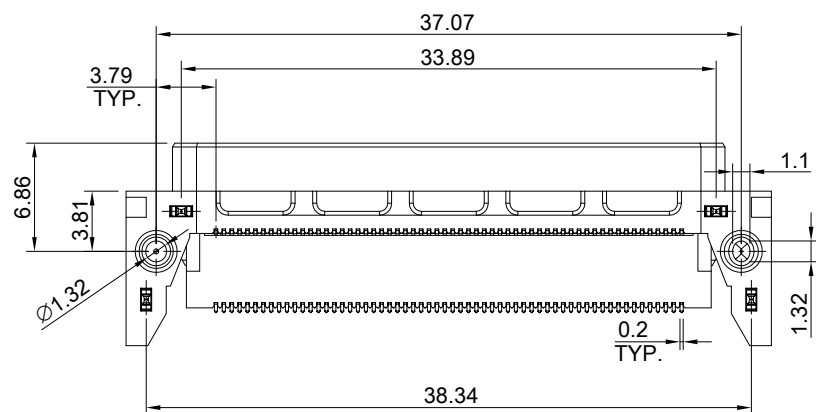

TITLE: 0.50mm 120 Pin Double Row Right Angle Terminal Assembly (Gen.3)			
DWG#: R-BM-059-9AX1		SHEET: 1/2	REV. C
UNIT: mm	SCALE: A4 2:1	FINISH:	CHECKED: Gary Kang
THIRD ANGLE PROJECTION		MATERIAL: RoHS Compliant	APPROVED: George Yang
TOLERANCE: Angle: ± 1° X. ± 0.25 .X ± 0.20 .XX ± 0.15		DRAWN: Tony	DATE: 08/04/2021

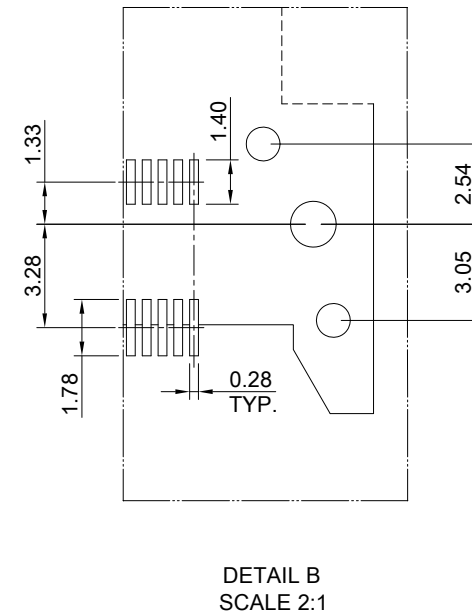
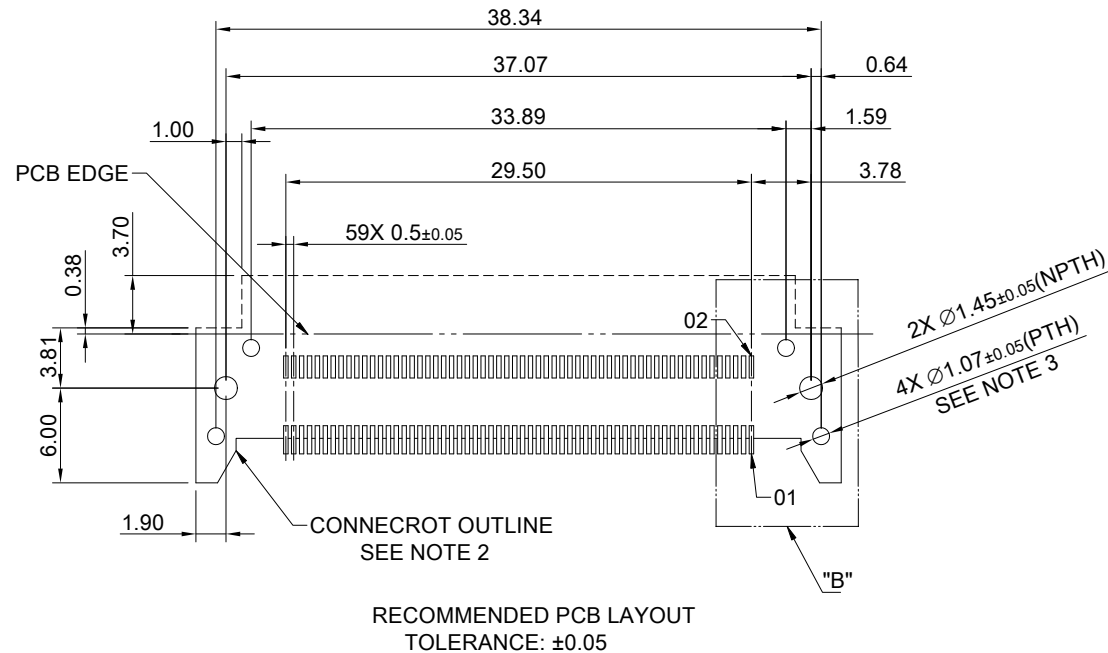

- NOTE :
1. ALL DIMENSIONS ARE SYMMETRIC ABOUT THE CENTERLINE.
 2. CONNECTOR OUTLINE. OTHER COMPONENTS PLACED ON PCB, SHALL AVOID THIS AREA.
 3. TO BE SOLDERED USING PASTE IN HOLE TECHNOLOGY.
 4. NOT RECOMMENDED FOR INVERTED REFLOW SOLDER.
 5. ASSEMBLY COPLANARITY OF DOUBLE ROW : 0.1MM

	TITLE: 0.50mm 120 Pin Double Row Right Angle Terminal Assembly (Gen.3)		
	DWG#: R-BM-059-9AX1		SHEET: 2/2
UNIT: mm	SCALE: A4 2:1	FINISH:	REV. C
	THIRD ANGLE PROJECTION	MATERIAL: RoHS Compliant	CHECKED: Gary Kang
TOLERANCE: Angle:± 1° X.± 0.15 .X± 0.1 .XX± 0.05		DRAWN: Tony	APPROVED: George Yang
			DATE: 08/04/2021