

DETAIL A
SCALE 4:1

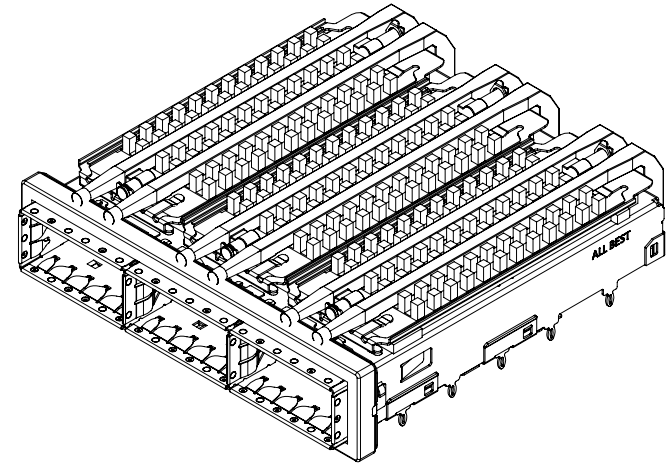

MATERIAL
 CAGE: NICKEL SILVER
 EMI SPRING: STAINLESS STEEL
 EMI GASKET FLANGE: STAINLESS STEEL
 EMI GASKET: CONDUCTIVE ELASTOMER
 HEAT SINK: ALUMINUM
 HEAT SINK CLIP: STAINLESS STEEL
 LIGHT PIPE: PC

FINISH
 HEAT SINK: ANODE PROCESS

NOTE
 ⚠ DIMENSION APPLIES WITH MODULE INSERTED IN CAGE

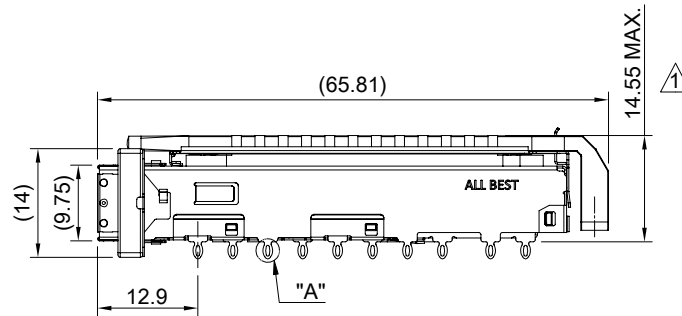
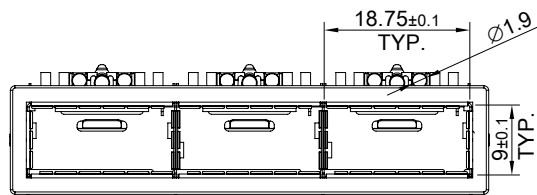

| | | | |
|--|---------------|--------------------------|------------------|
| TITLE: QSFP28 1X3 Cage Assembly w/ Light Pipe & Heat Sink(PCI) | | SHEET: 1/4 | REV. B |
| DWG#: R-OR-ZQ3-4CGE5-MK | | CHECKED: Gary Kang | |
| UNIT: mm | SCALE: A4 1:1 | APPROVED: George Yang | |
| TOLERANCE: X.± 0.25 .X± 0.20 .XX± 0.15 | | MATERIAL: RoHS Compliant | DATE: 04/27/2020 |
| THIRD ANGLE PROJECTION | | DRAWN: Calvin | |

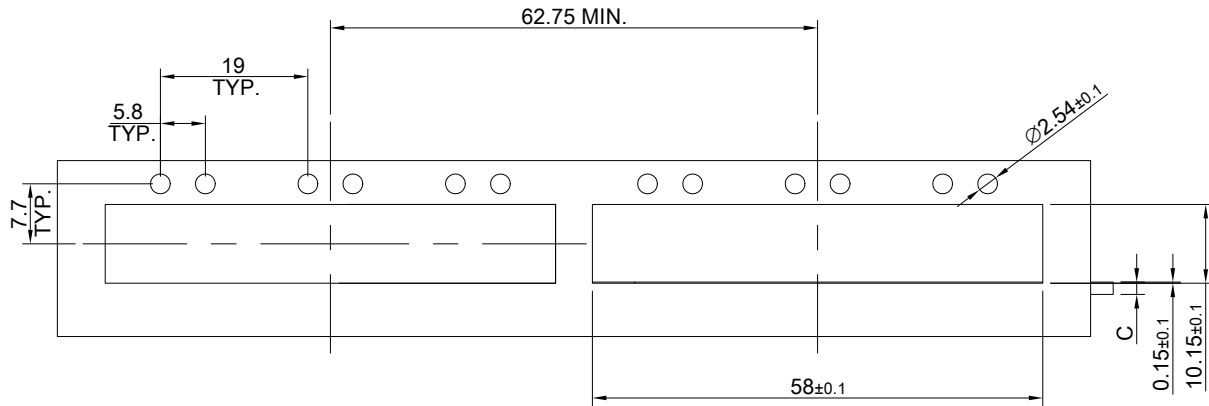

ONE SIDED CONFIGURATION

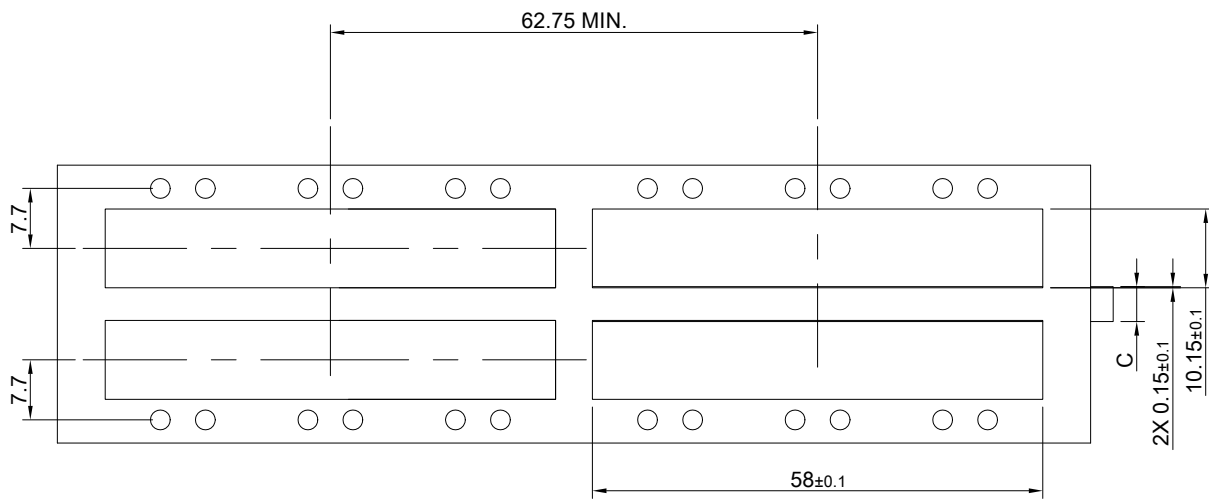
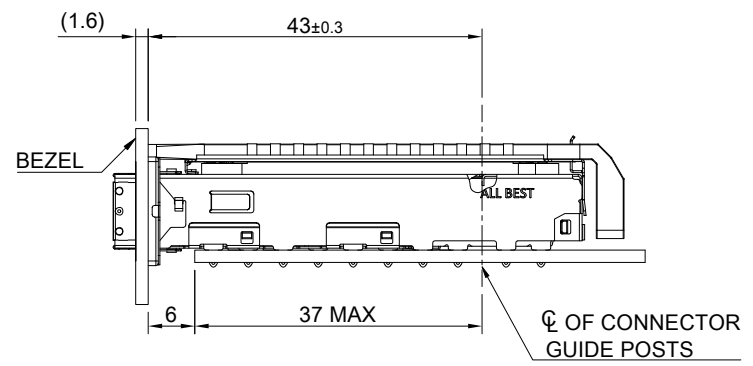

BELLY TO BELLY CONFIGURATION

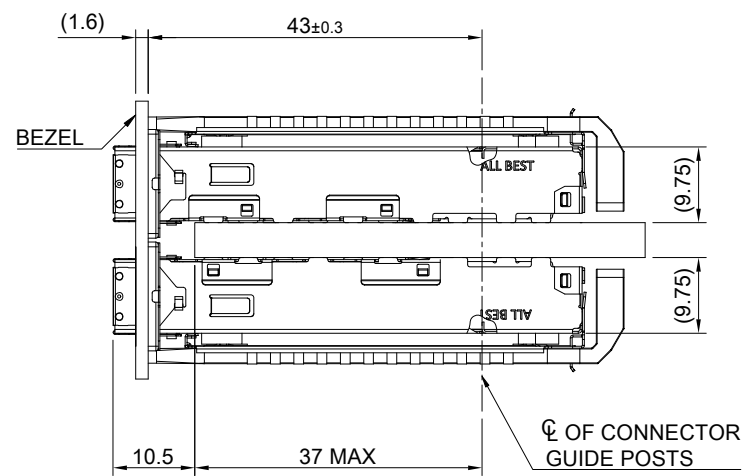

C = THICKNESS OF PC BOARD
 SINGLE SIDED= 1.6MM(MIN)
 DOUBLE SIDE= 4.5MM(MIN)



| | | | |
|--|---------------|-----------------------|------------------|
| TITLE: QSFP28 1X3 Cage Assembly w/ Light Pipe & Heat Sink(PCI) | | | |
| DWG#: R-OR-ZQ3-4CGE5-MK | | SHEET: 2/4 | REV. B |
| UNIT: mm | SCALE: A4 1:1 | CHECKED: Gary Kang | |
| THIRD ANGLE PROJECTION | | APPROVED: George Yang | |
| TOLERANCE: Angle: ± 1° | | DRAWN: Calvin | DATE: 04/27/2020 |
| X.± 0.15 .X± 0.10 .XX± 0.05 | | | |

1
2
3
4
5
6
7
8

1
2
3
4
5
6
7
8

A B C D E F G H

A B C D E F G H

DUAL LIGHT PIPE LED LAYOUT

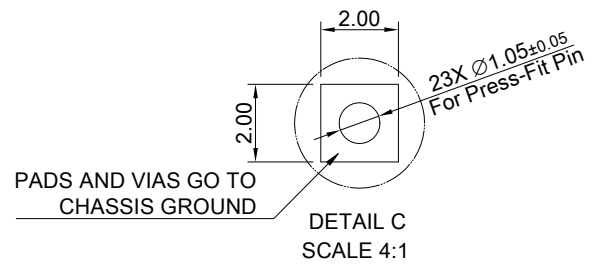
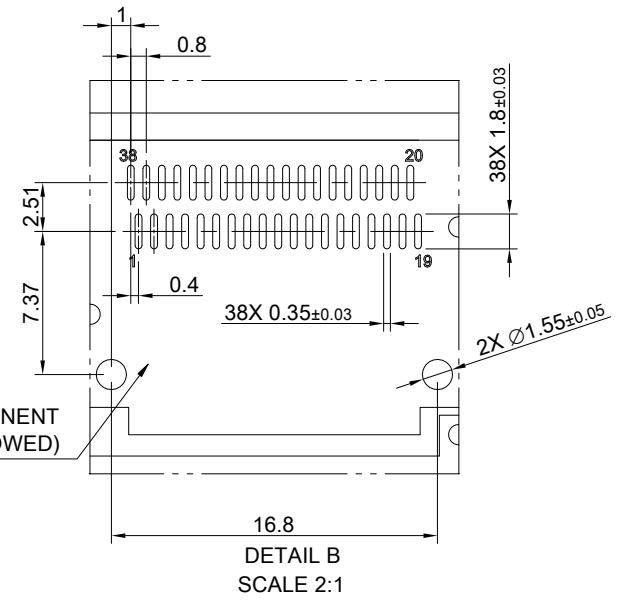
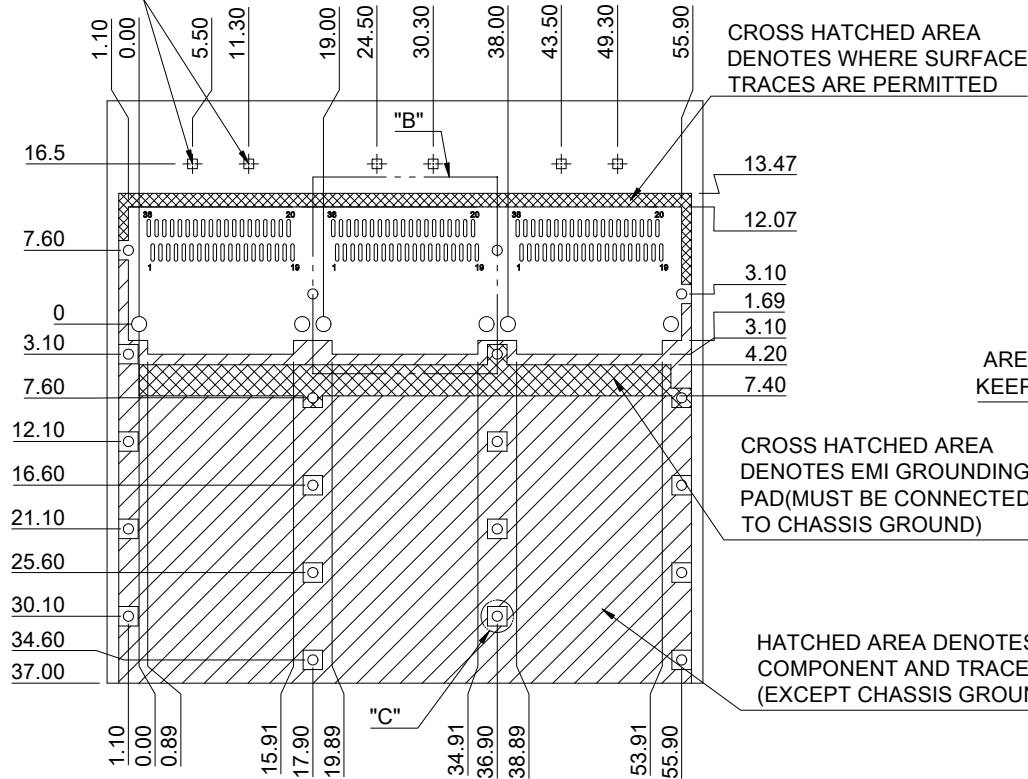

SINGLE SIDE PCB LAYOUT
TOLERANCE: ± 0.05
MINIMUM PCB THICKNESS OF 1.6 MM

| | | | | |
|---|---|---------------|--------------------------|-----------------------|
| <p>ALL BEST ALL BEST ELECTRONICS CO., LTD.</p> | TITLE: QSFP28 1X3 Cage Assembly w/ Light Pipe & Heat Sink(PCI) | | SHEET: 3/4 | REV. B |
| | DWG#: R-OR-ZQ3-4CGE5-MK | | CHECKED: Gary Kang | |
| | UNIT: mm | SCALE: A4 5:4 | FINISH: | APPROVED: George Yang |
| | TOLERANCE: Angle: $\pm 1^\circ$ X: ± 0.15 .X: ± 0.10 .XX: ± 0.05 | | MATERIAL: RoHS Compliant | DATE: 04/27/2020 |

DUAL LIGHT PIPE LED LAYOUT

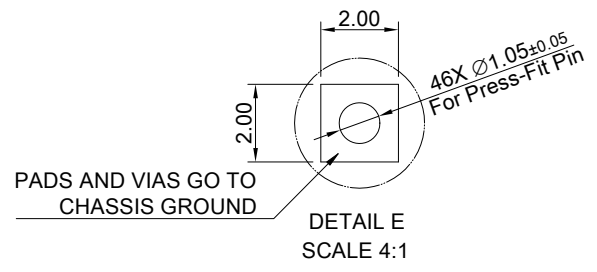
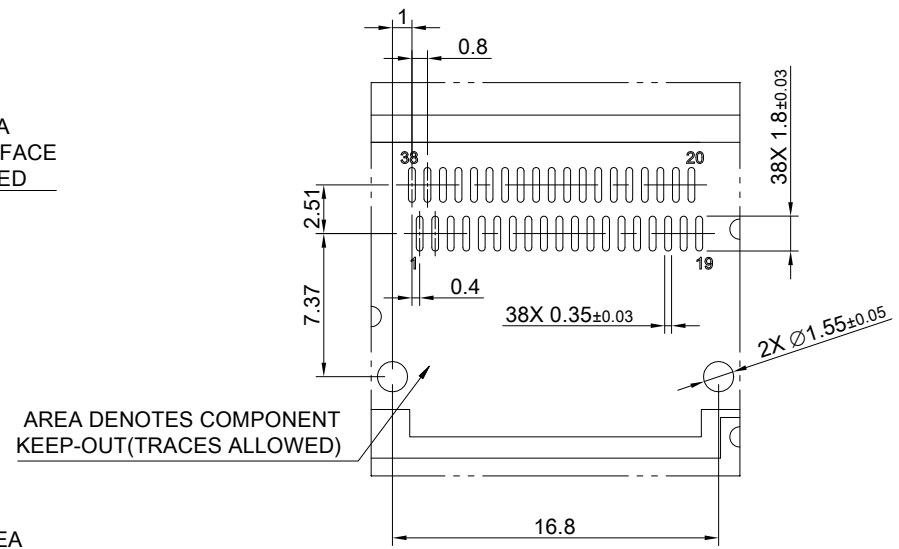
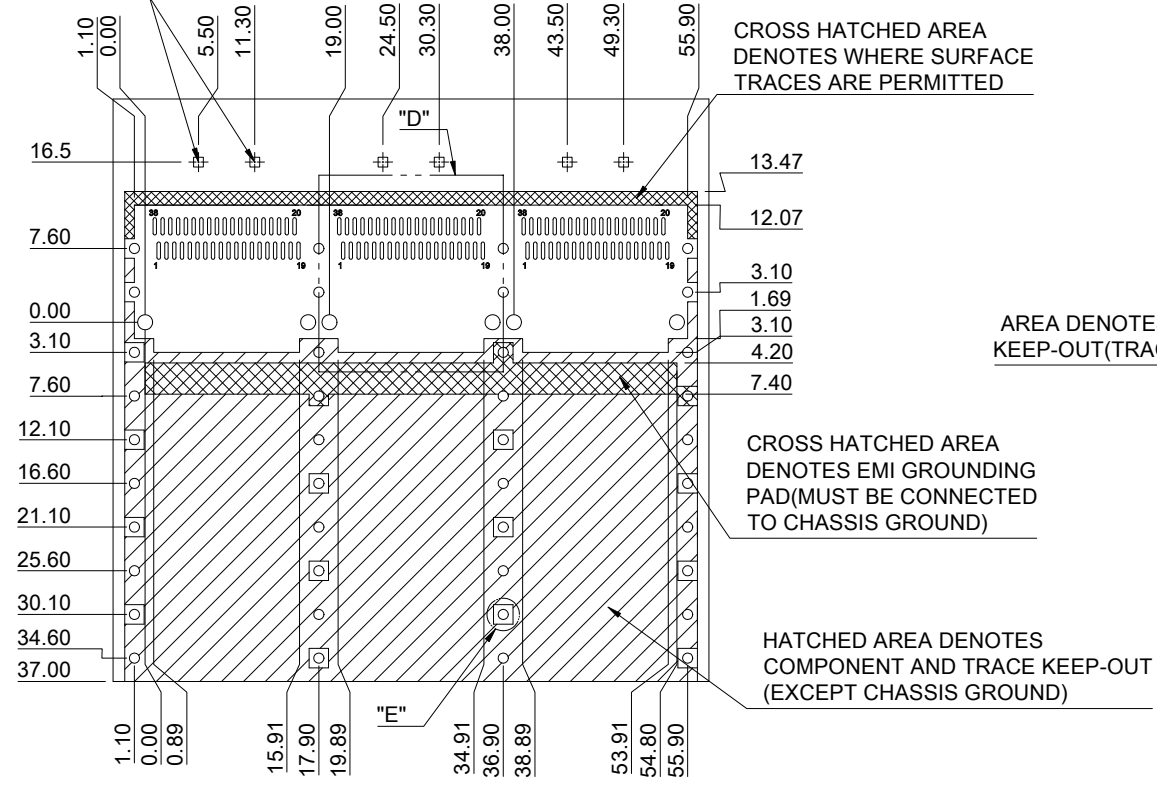

SINGLE SIDE PCB LAYOUT
TOLERANCE: ±0.05
MINIMUM PCB THICKNESS OF 4.5 MM

| | | | | |
|---|--|---------------------------------|------------------------------|--|
| <p>ALL BEST ALL BEST ELECTRONICS CO., LTD.</p> | TITLE: QSFP28 1X3 Cage Assembly w/ Light Pipe & Heat Sink(PCI) | | SHEET: 4/4 REV. B | |
| | DWG#: R-OR-ZQ3-4CGE5-MK | | CHECKED: <i>Gary Kang</i> | |
| UNIT: mm | SCALE: A4 5:4 | FINISH: | APPROVED: <i>George Yang</i> | |
| THIRD ANGLE PROJECTION | TOLERANCE: Angle: ± 1° X ± 0.15 .X ± 0.10 .XX ± 0.05 | MATERIAL: RoHS Compliant | DATE: 04/27/2020 | |
| | | DRAWN: Calvin | | |