

DETAIL A  
SCALE 5:1

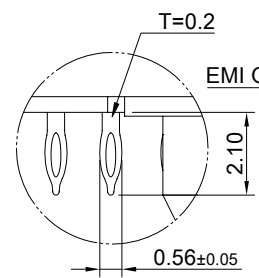

DETAIL B  
SCALE 5:1

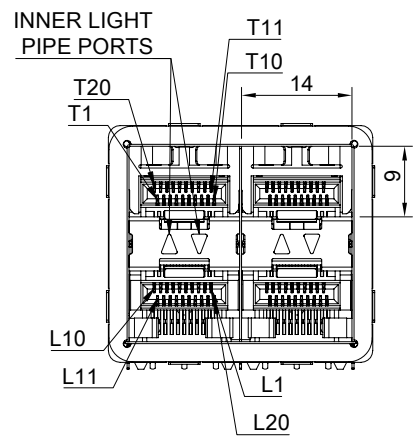
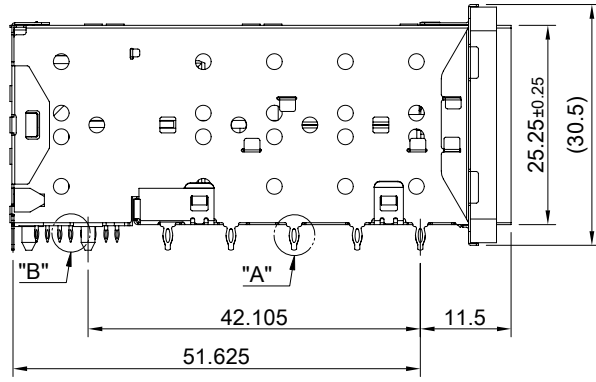
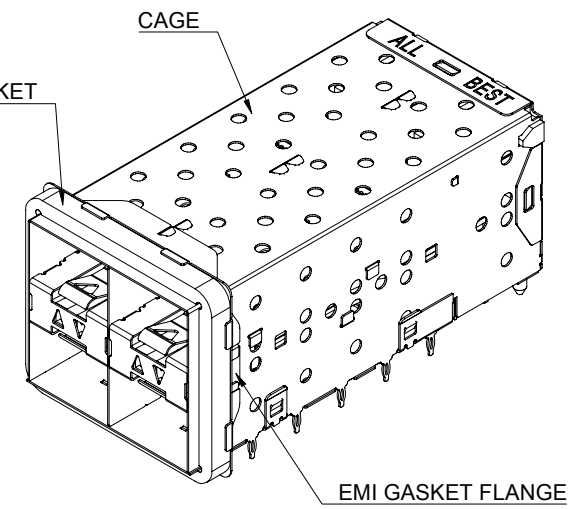

**MATERIAL**  
 CAGE: NICKEL SILVER  
 CONNECTOR: LCP 94V-0  
 COPPER ALLOY  
 EMI GASKET FLANGE: NICKEL SILVER  
 EMI GASKET: CONDUCTIVE ELASTOMER, (BLACK)  
 LIGHT PIPE: PC  
**FINISH**  
 CONTACT: 15μ" MIN. GOLD ON MATING END;  
 30μ" MIN. MATTE TIN ON TERMINATION END;  
 ALL UNDERPLATED 50μ" MIN. NICKEL  
**ELECTRICAL CHARACTERISTICS**  
 CONTACT CURRENT RATING: 0.5 AMPERE  
 VOLTAGE RATING: 30 VAC  
 CONTACT RESISTANCE: 80 mΩ MAX  
 DIELECTRIC WITHSTANDING VOLTAGE: 300 VAC

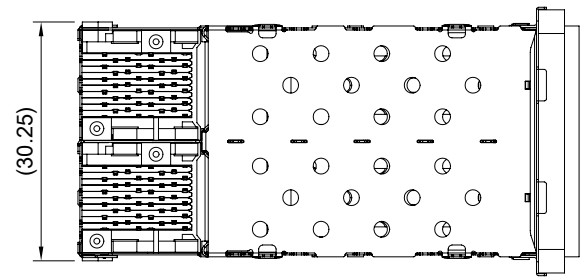

THIS PRINT IS  
**PRELIMINARY**  
 UNQUALIFIED PRODUCT  
 CONTACT PRODUCT ENGINEERING  
 BEFORE USING THIS PRINT



TITLE: Stacked SFP+ 2X2 ASS'Y w/ Internal Thermal Solution & Light Pipe			SHEET: 1/3		REV. REF	
DWG#: R-OP-008080-7-F-N2-36			CHECKED:		APPROVED:	
UNIT: mm	SCALE: A4 1:1	FINISH:		DATE: 03/15/2024		
TOLERANCE: Angle: ± 1° X.±0.25 .X±0.20 .XX±0.15		MATERIAL: RoHS Compliant		DRAWN: Laura		

$21 \times \varnothing 1.05 \pm 0.05$   
For Press-Fit Pin

CROSS HATCHED AREA DENOTES EMI  
GROUNDING PAD (MUST BE CONNECTED)  
TO CHASSIS GROUND

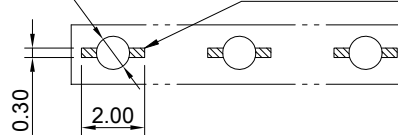

DETAIL C  
SCALE 4:1

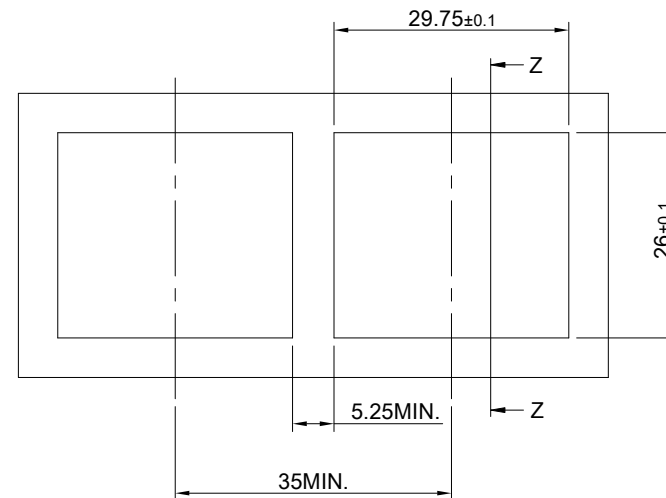

RECOMMENDED BEZEL CUT-OUT SPACING DETAIL  
BEZEL THICKNESS 0.8~2.6MM

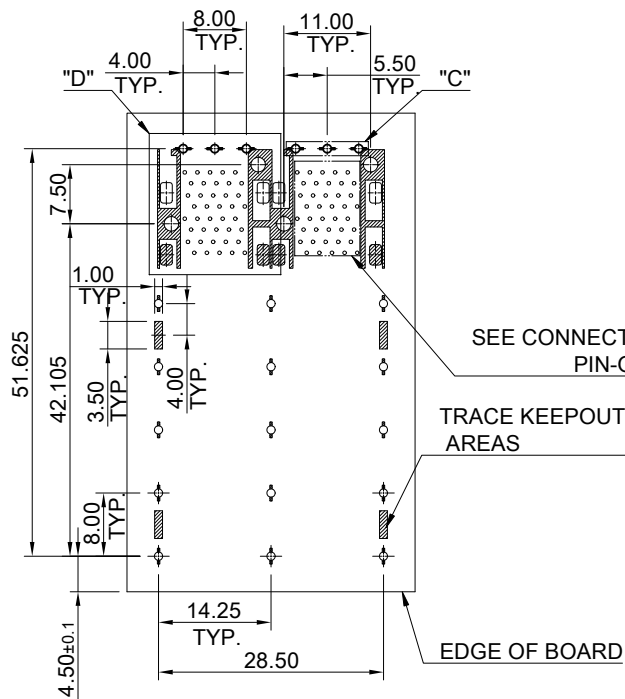

RECOMMENDED PCB LAYOUT  
TOLERANCE:  $\pm 0.05$   
MINIMUM PCB THICKNESS OF 1.57MM

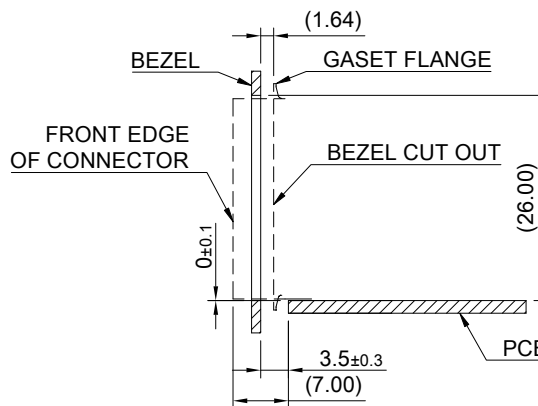

SECTION Z-Z

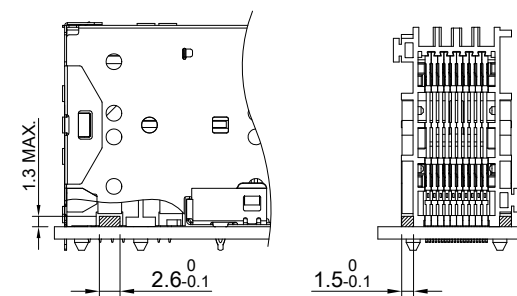

LED CLEARANCE REQUIREMENTS

THIS PRINT IS  
**PRELIMINARY**  
UNQUALIFIED PRODUCT  
CONTACT PRODUCT ENGINEERING  
BEFORE USING THIS PRINT



TITLE: Stacked SFP+ 2X2 ASS'Y w/ Internal Thermal Solution & Light Pipe			
DWG#: R-OP-008080-7-F-N2-36		SHEET: 2/3	REV. REF
UNIT: mm	SCALE: A4 1:1	FINISH:	
TOLERANCE: $\angle \pm 1^\circ$ $X. \pm 0.15$ $.X \pm 0.10$ $.XX \pm 0.05$		MATERIAL: RoHS Compliant	
THIRD ANGLE PROJECTION		DRAWN: Laura	
CHECKED:		APPROVED:	
DATE: 03/15/2024			

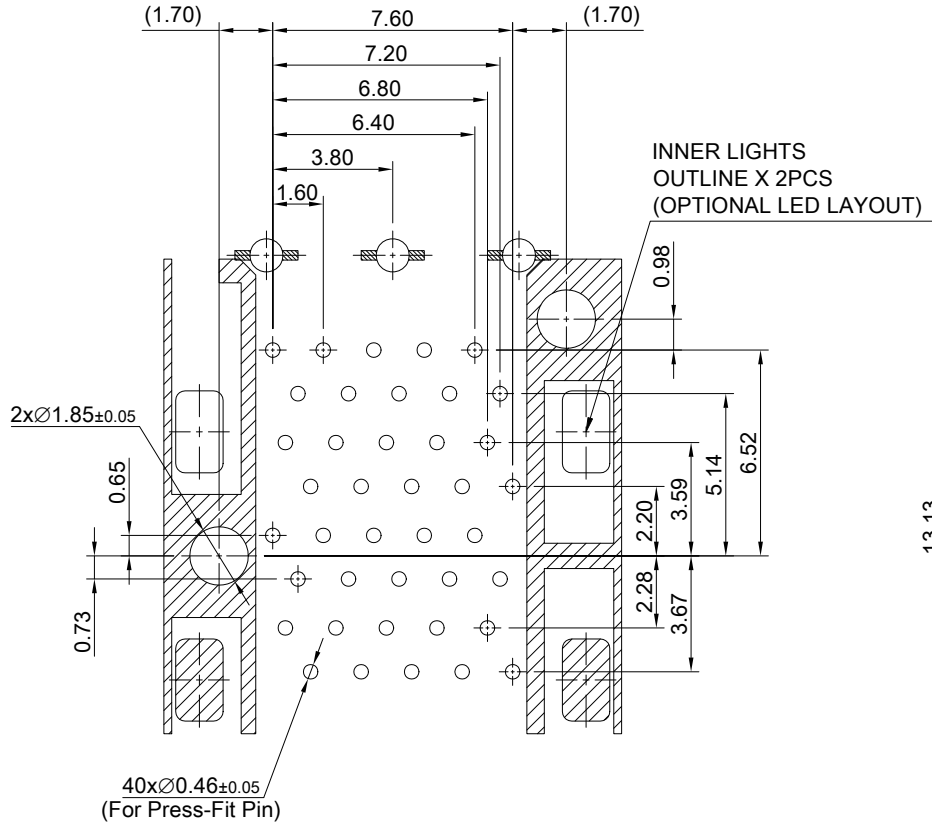

DETAIL D  
TOLERANCE: ±0.05

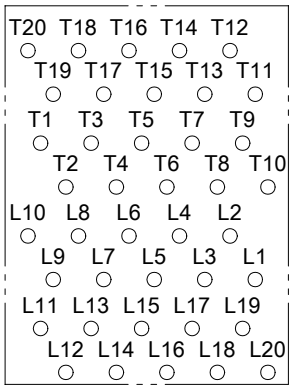

CONNECTOR PIN OUT

INNER LIGHTS  
OUTLINE X 2PCS  
(OPTIONAL LED LAYOUT)

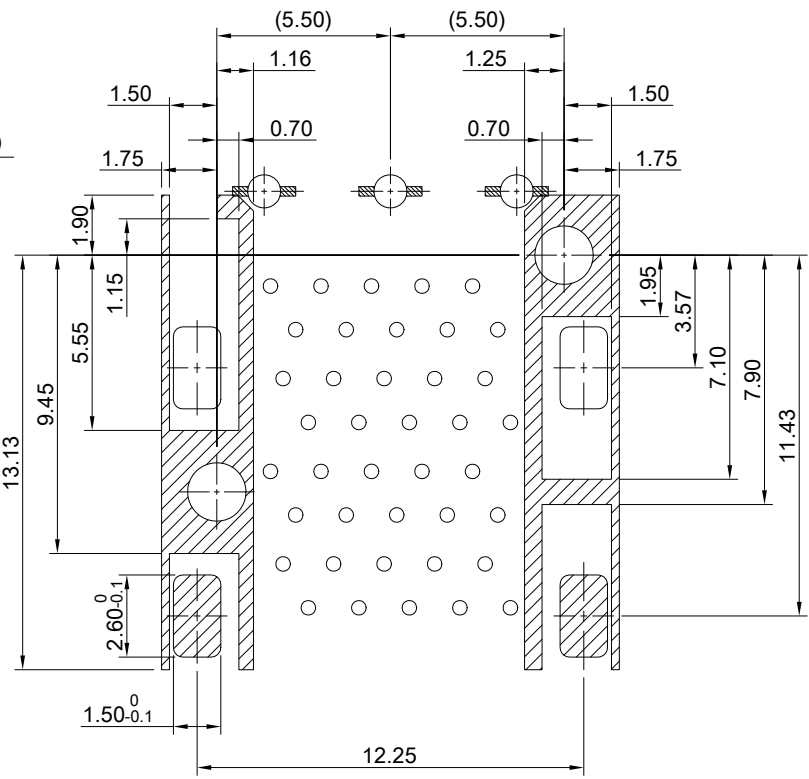

KEEPOUT ZONE DETAIL

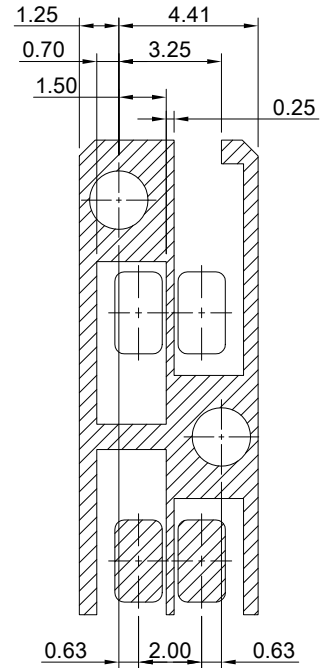

THIS PRINT IS  
**PRELIMINARY**  
UNQUALIFIED PRODUCT  
CONTACT PRODUCT ENGINEERING  
BEFORE USING THIS PRINT



TITLE: Stacked SFP+ 2X2 ASS'Y w/ Internal Thermal Solution & Light Pipe			
DWG#: R-OP-008080-7-F-N2-36		SHEET: 3/3	REV. REF
UNIT: mm	SCALE: A4 4:1	FINISH:	
TOLERANCE: Angle: ± 1° X.± 0.15 .X± 0.10 .XX± 0.05		MATERIAL: RoHS Compliant	
THIRD ANGLE PROJECTION		DRAWN: Laura	
CHECKED:		APPROVED:	
DATE: 03/15/2024			