

DETAIL A
SCALE 2:1

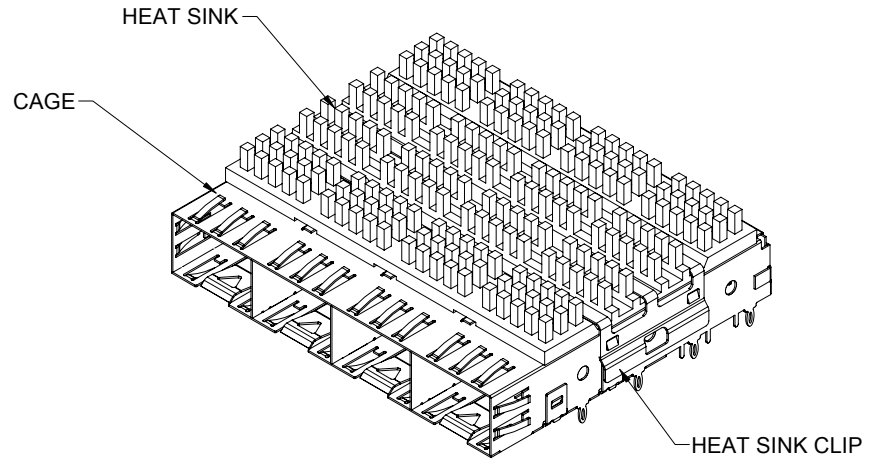
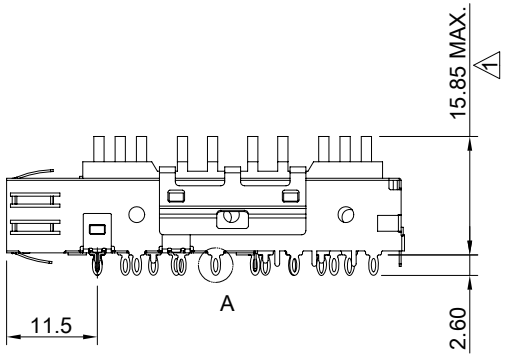

MATERIAL
 CAGE: NICKEL SILVER
 HEAT SINK: ALUMINUM
 HEAT SINK CLIP: STAINLESS STEEL

FINISH
 HEAT SINK: ANODE PROCESS

NOTE
 ▲ DIMENSION APPLIES WITH MODULE INSERTED IN CAGE



TITLE: SFP+ 1X4 Cage Assembly w/ SAN Heat Sink			
DWG#: R-SH-008080-6-K-02			SHEET: 1/2
			REV. B
UNIT: mm	SCALE: A4 1:1	FINISH:	
TOLERANCE: Angle: ± 1° X ± 0.25 .X ± 0.20 .XX ± 0.15		MATERIAL: RoHS Compliant	CHECKED: Gary Kang
		DRAWN: Jun	APPROVED: George Yang
		DATE: 08/19/2019	

A B C D E F G H

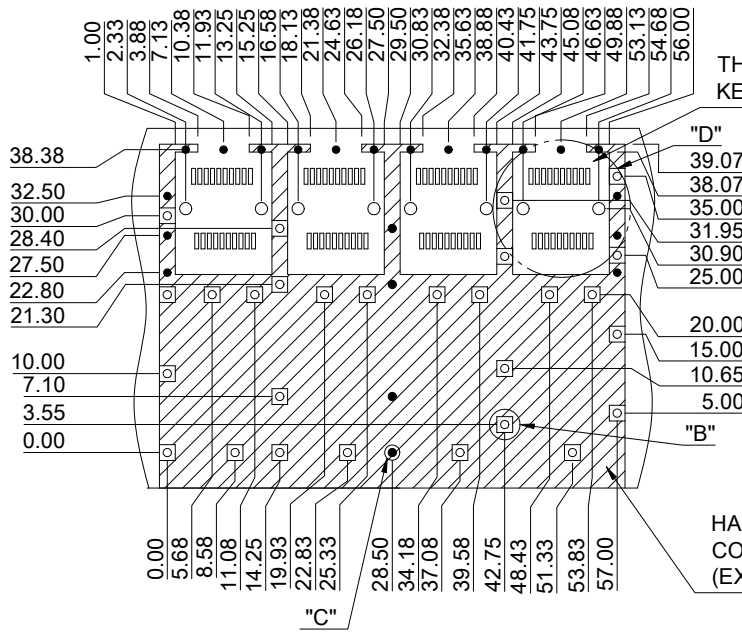

THIS AREA DENOTES COMPONENT KEEP-OUT (TRACES ALLOWED)

HATCHED AREA DENOTES COMPONENTS AND TRACE KEEP-OUT (EXCEPT CHASSIS GROUND)

RECOMMENDED PCB LAYOUT
TOLERANCE: ±0.05

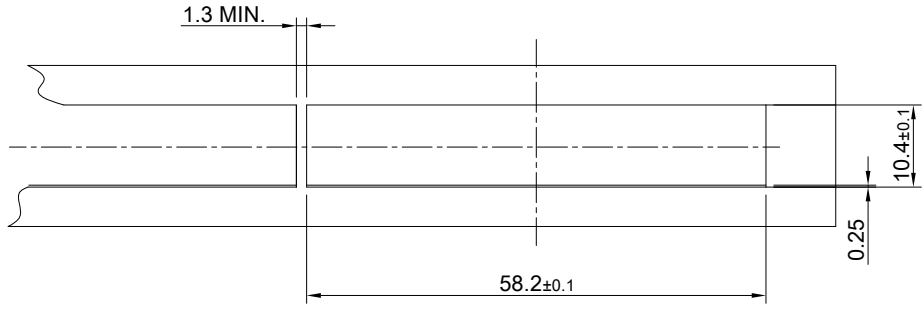

RECOMMENDED BEZEL CUT-OUT

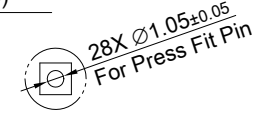

DETAIL B
SCALE 2:1

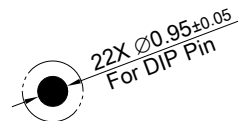

DETAIL C
SCALE 4:1

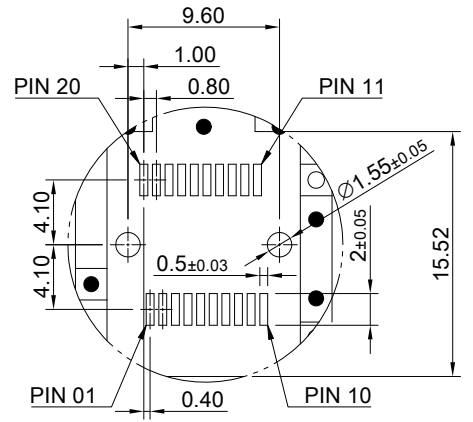

DETAIL D
SCALE 2:1

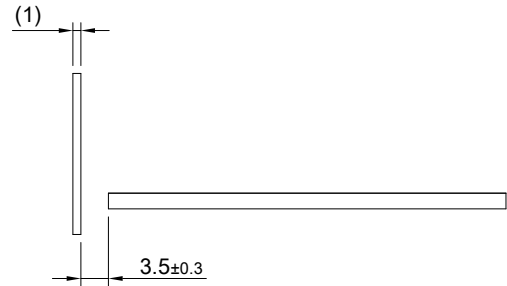

	TITLE: SFP+ 1X4 Cage Assembly w/ SAN Heat Sink		SHEET: 2/2	REV. B
	DWG#: R-SH-008080-6-K-02		CHECKED: Gary Kang	
	UNIT: mm	SCALE: A4 1:1	FINISH:	APPROVED: George Yang
	TOLERANCE: Angle: ± 1° X ± 0.15 .X ± 0.10 .XX ± 0.05		MATERIAL: RoHS Compliant	DATE: 08/19/2019
THIRD ANGLE PROJECTION		DRAWN: Jun		

A B C D E F G H