

ELECTRICAL CHARACTERISTICS

CONTACT CURRENT RATING : 0.5 AMPERE
 DIELECTRIC WITHSTANDING VOLTAGE : 250 VAC
 INSULATION RESISTANCE : 500 MEGOHMS MIN.
 CONTACT RESISTANCE : 80 MILLIOHMS MAX.

MATERIALS

CONTACTS : COPPER ALLOY
 INSULATOR : THERMOPLASTIC 94V-0
 SHELL : COLD ROLLER STEEL

FINISHES

CONTACT : 30 μ" MIN. GOLD ON MATING END;
 ALL UNDERPLATED NICKEL
 SHELL : NICKEL OVER COPPER

ENVIRONMENT

OPERATION TEMPERATURE : -55°C TO + 85°C
 COMPATIBLE CABLE : AWG #30 (IDC GAP 0.17mm)

NOTES

1. MATERIAL : THERMOPLASTIC
2. THE STRAIN RELIEF WILL NOT BE SOLD SEPARATELY
3. SHIP WITH TWO R-SR-008068-01

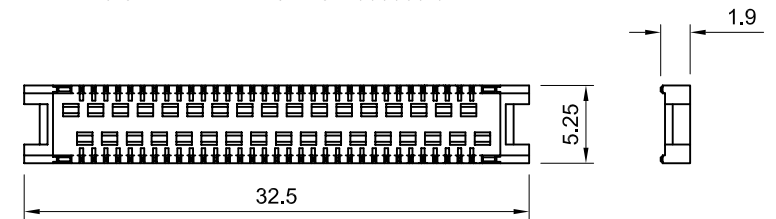

P/N:R-SR-008068-01

SCALE 2:1

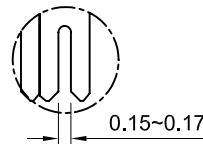

DETAIL A-A SECTION FOR 30AWG

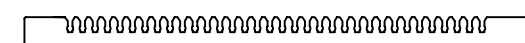
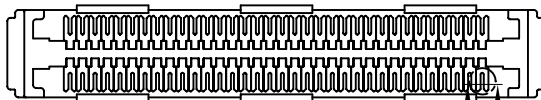
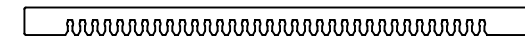

ALL BEST
 ALL BEST
 ELECTRONICS
 CO., LTD.

TITLE : VHDCI 0.8mm Plug - Two Side , Two Row

DWG# : R-HI-008068-A

SHEET: 1 / 1
 REV. C

UNIT : mm
 SCALE : 2 : 1

FINISH :
 MATERIAL :
 RoHS Compliant

CHECKED:
 Glen Cheng

THIRD ANGLE PROJECTION

MATERIAL :
 RoHS Compliant

APPROVED:
 George Yang

TOLERANCE : Angle:±1°
 X,±0.25 .X±0.2 .XX±0.15

DRAWN:
 Gary

DATE:
 07/01/2010