

**MATERIAL**  
 CONTACTS: COPPER ALLOY  
 INSULATOR: LCP THERMOPLASTIC 94V-0

**FINISH**  
 CONTACTS: 5μ" MIN. GOLD ON MATING END;  
 100μ" MIN. MATTE TIN ON SOLDER FOOT AREA  
 ALL UNDERPLATED NICKEL

**ELECTRICAL CHARACTERISTICS**  
 CONTACT CURRENT RATING: 2 AMPERE  
 VOLTAGE RATING: 275VAC  
 MAX CYCLES: 100

**ENVIRONMENT**  
 OPERATION TEMPERATURE: -55°C TO 125°C  
 SMT TEMPERATURE: 260°C

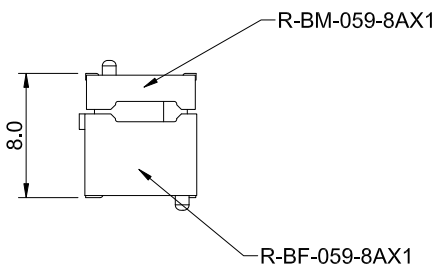

The combined height of the male and female connectors after mating.

	<b>TITLE:</b> 0.50mm Double Row Socket Strip (Gen.3)			<b>SHEET:</b> 1/2		<b>REV.</b> A		
	<b>DWG#:</b> R-BM-059-8AX1			<b>CHECKED:</b> Gary Kang		<b>APPROVED:</b> George Yang		
	<b>UNIT:</b> mm	<b>SCALE:</b> A4 2:1	<b>FINISH:</b>	<b>MATERIAL:</b> RoHS Compliant		<b>DATE:</b> 08/27/2018		
	<b>THIRD ANGLE PROJECTION</b>		<b>DRAWN:</b> Sheng					
<b>TOLERANCE:</b> Angle: ± 1° X: ± 0.25 .X ± 0.20 .XX ± 0.15								

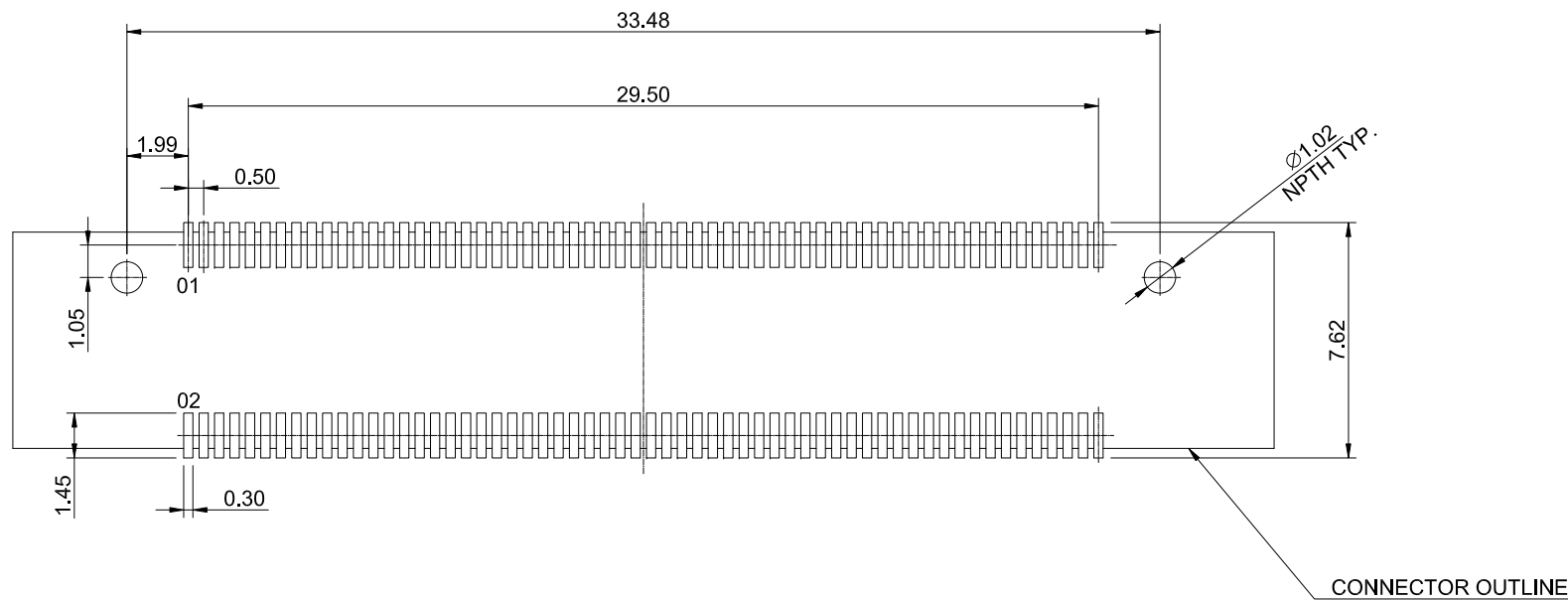

RECOMMENDED PCB LAYOUT  
TOLERANCE:  $\pm 0.05$

CONNECTOR OUTLINE



ALL BEST  
ELECTRONICS  
CO., LTD.

TITLE: 0.50mm Double Row Socket Strip (Gen.3)

DWG#: R-BM-059-8AX1

UNIT:  
mm

SCALE:  
A4 4:1

FINISH:

THIRD ANGLE  
PROJECTION

MATERIAL:  
RoHS Compliant

TOLERANCE: Angle:  $\pm 1^\circ$   
X:  $\pm 0.15$  .X:  $\pm 0.10$  .XX:  $\pm 0.05$

DRAWN:  
Sheng

SHEET: 2/2  
REV. A

CHECKED:  
Gary Kang

APPROVED:  
George Yang

DATE:  
08/27/2018