

DETAIL A
SCALE 2:1

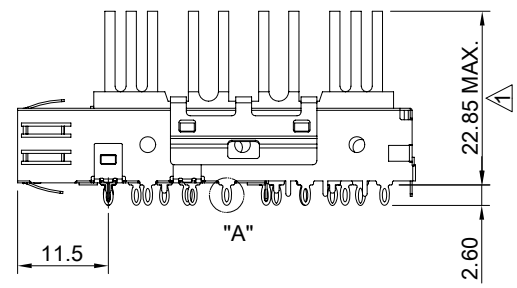
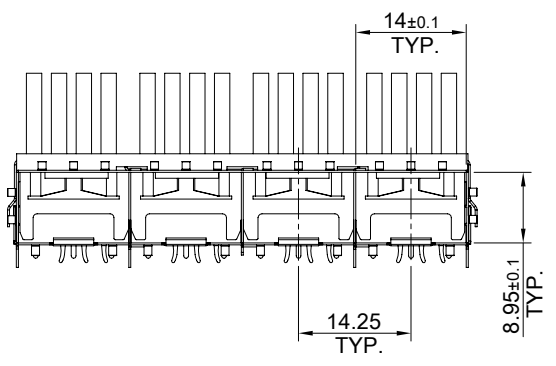
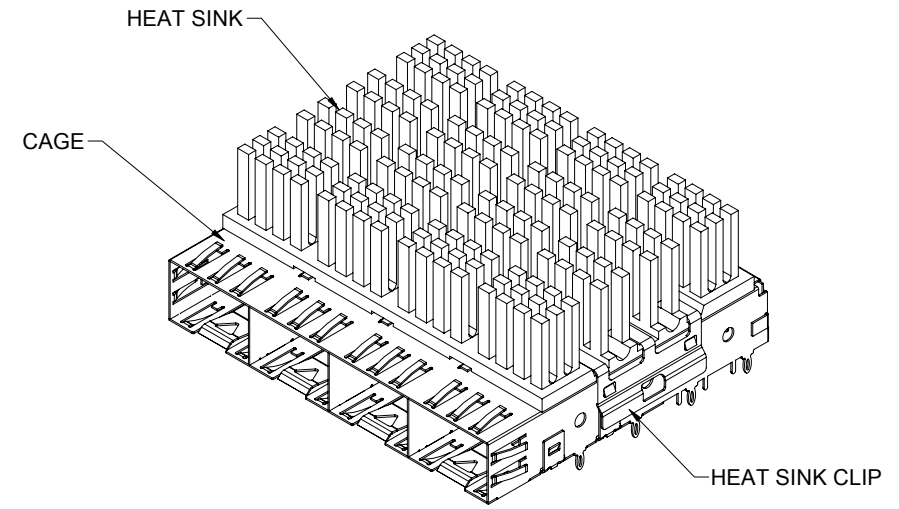

MATERIAL
 CAGE: NICKEL SILVER
 HEAT SINK: ALUMINUM
 HEAT SINK CLIP: STAINLESS STEEL

FINISH
 HEAT SINK: ANODE PROCESS

NOTE
 ▲ DIMENSION APPLIES WITH MODULE INSERTED IN CAGE



TITLE: SFP+ 1X4 Cage Assembly w/ NET Heat Sink				
DWG#: R-SH-008080-6-K-01			SHEET: 1/2	REV. C
UNIT: mm	SCALE: A4 1:1	FINISH:		CHECKED: Gary Kang
TOLERANCE: Angle: ± 1°		MATERIAL: RoHS Compliant		APPROVED: George Yang
X. ± 0.25 .X ± 0.20 .XX ± 0.15		DRAWN: Jun		DATE: 08/19/2019

A B C D E F G H

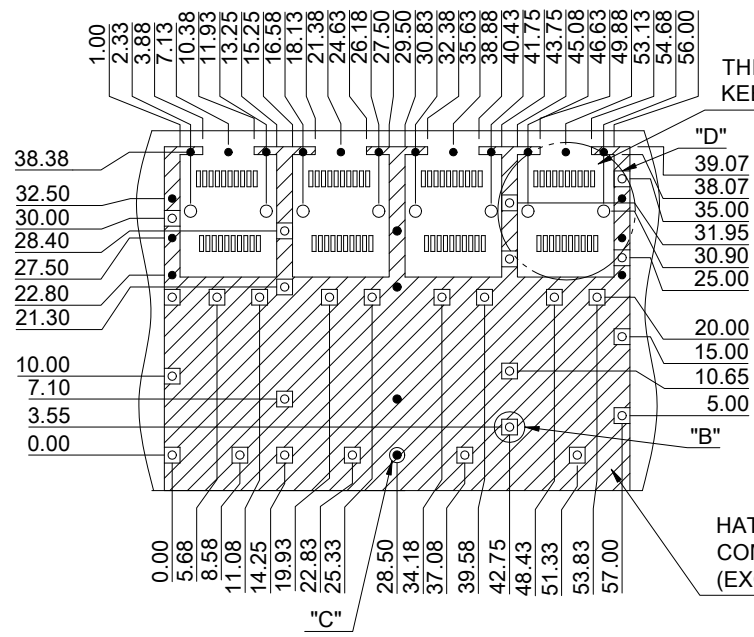

THIS AREA DENOTES COMPONENT KEEP-OUT (TRACES ALLOWED)

HATCHED AREA DENOTES COMPONENTS AND TRACE KEEP-OUT (EXCEPT CHASSIS GROUND)

RECOMMENDED PCB LAYOUT TOLERANCE: ± 0.05

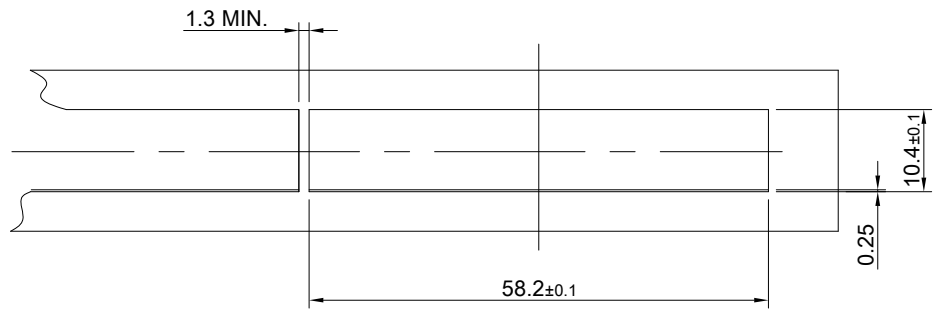

RECOMMENDED BEZEL CUT-OUT

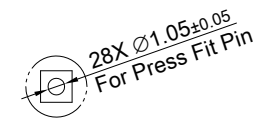

DETAIL B SCALE 2:1

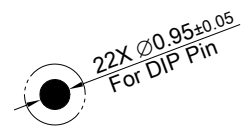

DETAIL C SCALE 4:1

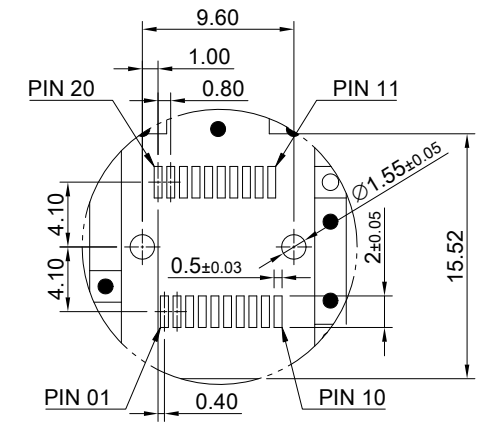

DETAIL D SCALE 2:1

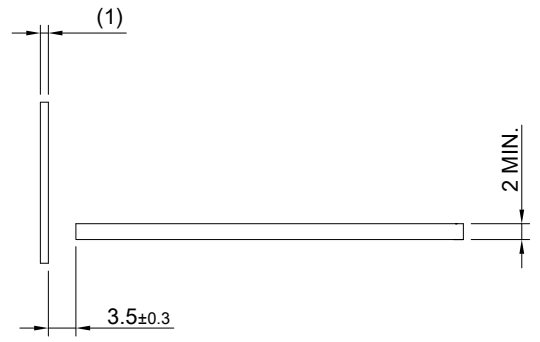

TITLE: SFP+ 1X4 Cage Assembly w/ NET Heat Sink			
DWG#: R-SH-008080-6-K-01		SHEET: 2/2	REV. C
UNIT: mm	SCALE: A4 1:1	CHECKED: Gary Kang	
TOLERANCE: Angle: $\pm 1^\circ$ X. ± 0.15 .X ± 0.10 .XX ± 0.05		MATERIAL: RoHS Compliant	APPROVED: George Yang
		DRAWN: Jun	DATE: 08/19/2019

A B C D E F G H