

A B C D E F G H

1  
2  
3  
4  
5  
6  
7  
8

1  
2  
3  
4  
5  
6  
7  
8

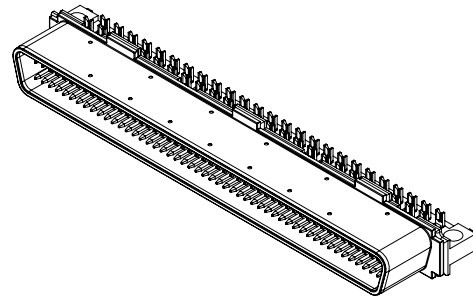

**ELECTRICAL CHARACTERISTICS**  
 CONTACT CURRENT RATING: 1 AMPERE  
 DIELECTRIC WITHSTANDING VOLTAGE: 500VAC  
 INSULATION RESISTANCE: 1000 MEGOHMS MIN.  
 CONTACT RESISTANCE: 25 MILLIOHMS MAX.

**MATERIALS**  
 CONTACTS: COPPER ALLOY  
 INSULATOR: THERMOPLASTIC 94V-0  
 SHELL: COLD ROLLER STEEL

**FINISHES**  
 CONTACT: 5μ" MIN. GOLD ON MATING END;  
 ALL UNDERPLATED NICKEL  
 SHELL: NICKEL OVER COPPER

**ENVIRONMENT**  
 OPERATION TEMPERATURE: -55°C TO + 85°C  
 COMPATIBLE CABLE: AWG #28

**NOTES**  
 1.MATERIAL: THERMOPLASTIC  
 2.THE STRAIN RELIEF WILL NOT SOLD SEPARATELY  
 3.SHIP WITH TWO R-SR-013100-01

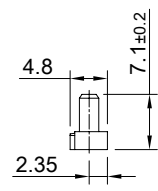
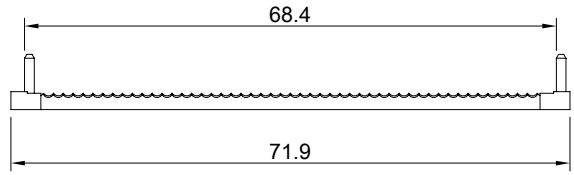
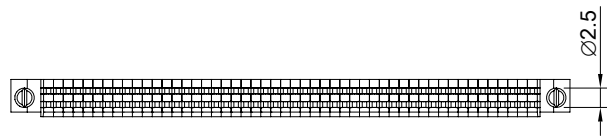
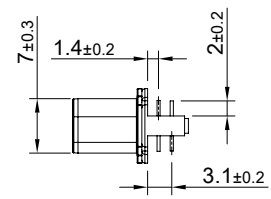
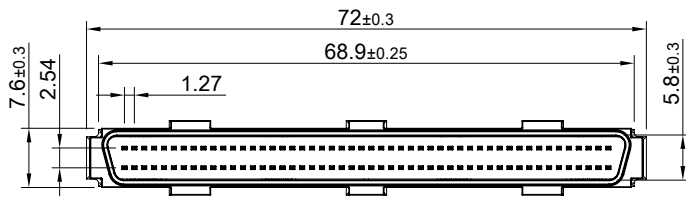
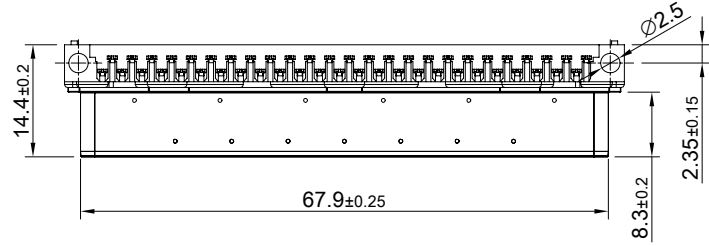

P/N:R-SR-013100-01

|   |   |               |                          |                       |
|---|---|---------------|--------------------------|-----------------------|
| <br><b>ALL BEST</b><br>ALL BEST<br>ELECTRONICS<br>CO., LTD. | TITLE: 1.27mm Cable Plug                              |               | SHEET: 1/1               | REV. D                |
|   | DWG#: R-ZI-013100                                     |               | CHECKED: Gary Kang       |                       |
|   | UNIT: mm  | SCALE: A4 1:1 | FINISH:                  | APPROVED: George Yang |
|   | TOLERANCE: Angle: ± 1°<br>X.± 0.25 .X± 0.20 .XX± 0.15 |               | MATERIAL: RoHS Compliant | DATE: 08/04/2023      |
| THIRD ANGLE PROJECTION                                      |   | DRAWN: Joe    |                          |                       |

A B C D E F G H